

Rec 19.50

(4)

77

**RESOLUTION**

INSTR # 200309247  
OR BK 01121 PGS 0398-0401  
RECORDED 03/13/2003 11:09:42 AM  
J. M. OXLEY JR  
CLERK OF CIRCUIT COURT  
FLORIDA  
RECORDING FEES 19.50

91-71

**A RESOLUTION CLOSING, VACATING AND ABANDONING OF THOSE CERTAIN RIGHTS-OF-WAY OR THE RENOUNCING AND DISCLAIMING OF ANY RIGHT OR INTEREST OF SAID NASSAU COUNTY, FLORIDA, AND THE PUBLIC IN SAID RIGHTS-OF-WAY OR ALLEYS.**

WHEREAS, a public hearing was held at 7:05 o'clock P.M., on the 15th day of April, 1991, at the Yulee County Building, Nassau County, Florida, pursuant to a notice duly published as provided by law upon the petition of HARRY VANZANT requesting this Board to close, vacate and abandon the roadways or alleyways hereinafter described and to renounce and disclaim the right of the public and the County in and to said roadways and alleyways described as follows:

SEE ATTACHED SCHEDULE "A"

WHEREAS, no one appeared at said hearing to oppose said Petition, and

WHEREAS, this Board finds that said roadways and alleyways lie wholly without the corporate limits of any municipality and that this Board is authorized to close said roadways or alleyways by the Authority granted in Section 336.09, Florida Statutes, and

WHEREAS, this Board has determined that it is in the best interest of Nassau County and the public that said roadways or alleyways be closed, vacated and abandoned and that the interest of Nassau County and the public be renounced and disclaimed therein.

**NOW, THEREFORE, BE IT RESOLVED** by the Board of County Commissioners of Nassau County, Florida, in meeting duly assembled that said roadways or alleyways as hereinbefore described in the preamble hereto be, and the same is, hereby closed, vacated and abandoned to the extent as if said roadways or alleyways had never been delineated on said plat.

**BE IT FURTHER RESOLVED** that the right and interest of Nassau County and the public in said roadways or alleyways above described by, and the same are hereby renounced and disclaimed, and any easement heretofore owned, held, claimed or used by or on behalf of the public therein is hereby abrogated.

\*Joan

BE IT FURTHER RESOLVED that the Clerk of this Board shall cause to be published, within thirty (30) days after the adoption of this Resolution, in one issue of the \_\_\_\_\_ NASSAU COUNTY RECORD a notice of the adoption of this Resolution closing, vacating, and abandoning all of those certain roadways or alleyways as hereinbefore described in the preamble hereto, and the renouncing and disclaiming of any right or interest of the County and the public in said roadways or alleyways.

NOTICE IS HEREBY GIVEN that the Board of County Commissioners of Nassau County, Florida, did on the 15th day of April, 1991, adopt a Resolution closing, vacating, and abandoning those certain roadways or alleyways, described as follows:

That property as described in the attached exhibit "A"

BOARD OF COUNTY COMMISSIONERS  
NASSAU COUNTY, FLORIDA

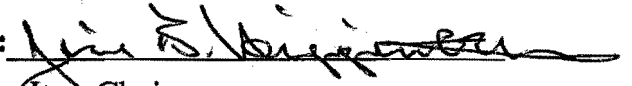
BY:   
Its: Chairman

ATTEST:

BY:   
T. J. Greeson  
Its: Ex-Officio Clerk

ALL THAT CERTAIN PIECE, PARCEL, OR TRACT OF LAND LYING AND BEING SITUATE IN SECTIONS 3 AND 10, TOWNSHIP 3 NORTH, RANGE 24 EAST, NASSAU COUNTY, FLORIDA; ALSO DESCRIBED AS A PORTION OF A PLATTED RIGHT-OF-WAY AS SHOWN ON THE PLAT OF JOSEPH DUNN'S FRUIT AND TRUCK FARMS, AS RECORDED IN DEED BOOK B-10, PAGE 48, OF THE CURRENT PUBLIC RECORDS OF NASSAU COUNTY, FLORIDA; SAID PARCEL BEING MORE PARTICULARLY DESCRIBED AS FOLLOWS:

## PARCEL NO. 1

BEGINNING at the North end of the intersection of the platted right-of-ways as shown on said plat at the Northeast corner of said Section 10 and proceeding South to the intersection with the Northerly right-of-way line of County Road No. 108 (a 66-foot county right-of-way, being a paved road), including the entire width of said platted right-of-way. Said road being unnamed and not being open.

## PARCEL NO. 2

BEGINNING at the East end of the intersection of the platted right-of-ways as shown on said plat at the Northeast corner of said Section 10; and proceeding West to the West end of the intersection of the platted right-of-ways as shown on said plat at the Northwest corner of the Northeast  $\frac{1}{4}$  of said Section 10; including the entire width of said platted right-of-way. Said road being unnamed and not being open.

## PARCEL NO. 3

BEGINNING at the North end of the intersection of the platted right-of-ways as shown on said plat at the Northwest corner of the Northeast  $\frac{1}{4}$  of said Section 10 and proceeding South to the intersection with the Northerly right-of-way line of County Road No. 108 (a 66-foot county right-of-way, being a paved road); including the entire width of said right-of-way. Said road being unnamed and not being open.

INSTR # 200309247  
OR BK 01121 PG 0400

Map of Joseph Swain's Fruit and Truck Farms.

Sections 1, 2, 3, 4, 10, 11, 14, 15, 16, 21, 22, 26, 31, 34, N Range 24 E.  
 Sections 30, 31, and 32, T4 N.

INSTR # 200309247  
 OR BK 01121 PG 0401

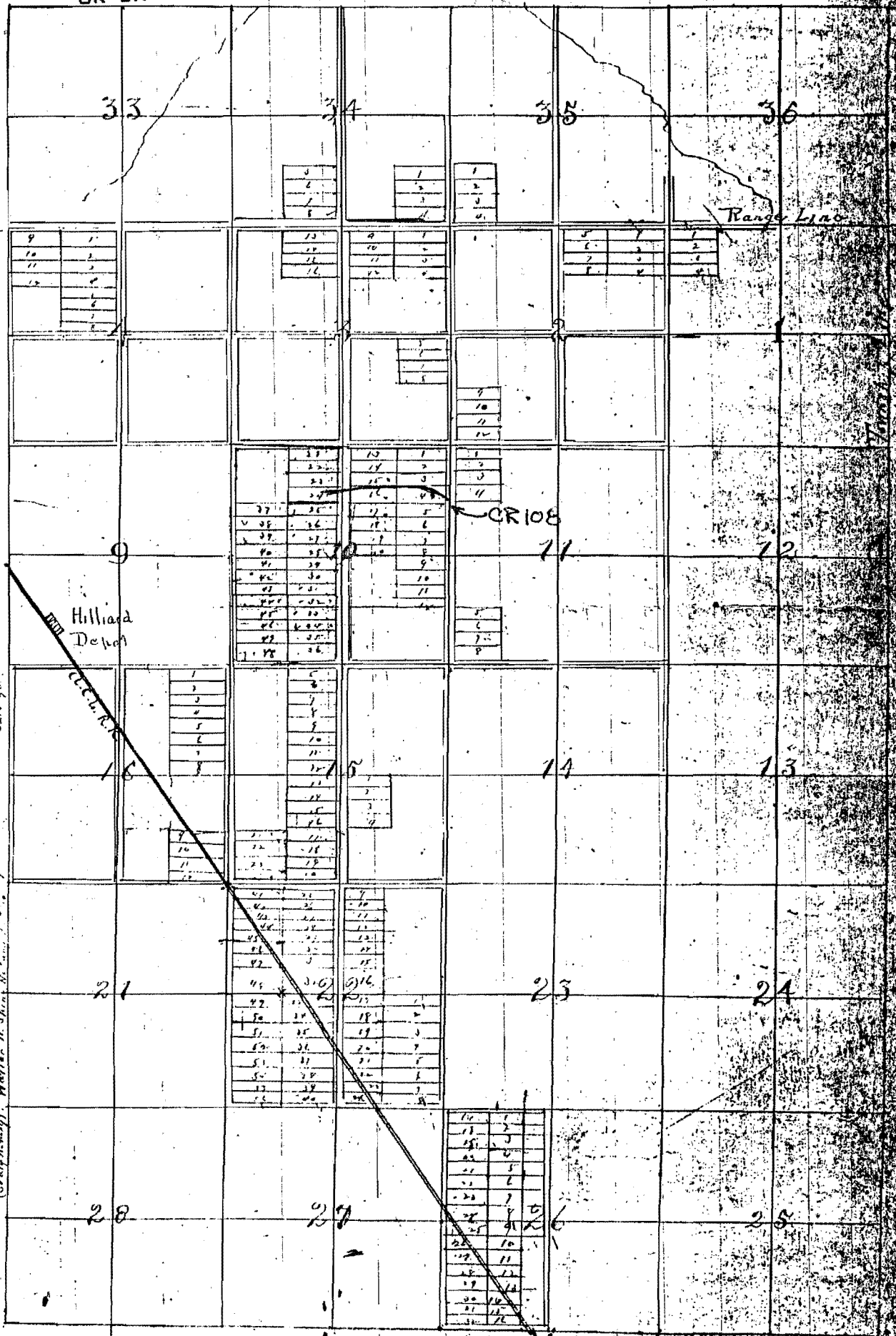
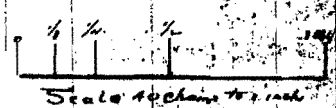

Do it remember, that on this 15th day of May 1909 there personally appearing before me J. M. Swain, being duly sworn, did acknowledge and certify that the above described land is a tract and farm of Joseph Swain's Fruit and Truck Farms in Sections 1, 2, 3, 4, 10, 11, 14, 15, 16, 21, 22, 26, 31, 34, N Range 24 E, T4 N, R24 E, in Hilliard De Wolf Co., Fla. and, accordingly, I have hereunto set my hand and the seal of my office, this 15th day of May, 1909. J. M. Swain, Surveyor.

Filed and Rec'd May 14th 1909.  
 Edwin R. Williams, Clerk